

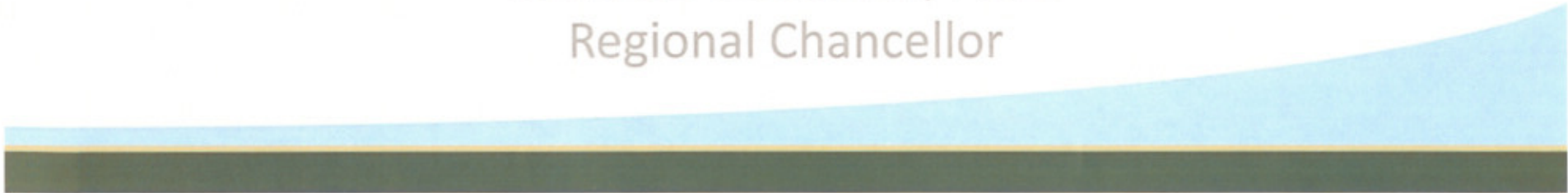

# **the** POLYTECHNIC

09.15.11

Marshall Goodman, Ph.D.  
Regional Chancellor



**What is our unique  
approach to higher  
education?**



“Here in Florida, we have something special we never enjoyed at Disneyland...the blessing of size. There’s enough land here to hold all the ideas and plans we can possibly imagine.”

*Walt Disney*



# Imagine

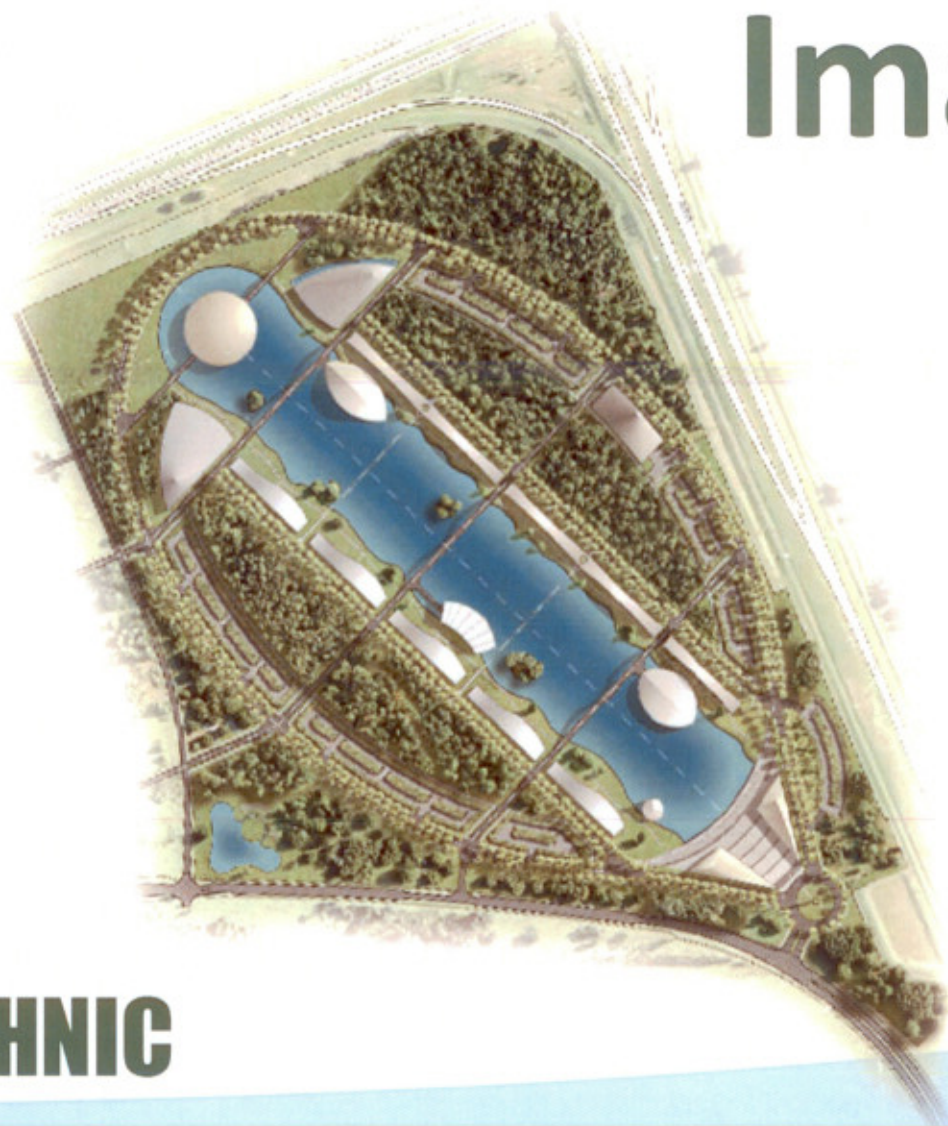

**the POLYTECHNIC**



# Building Florida's High-Tech Corridor

Access at the  
epicenter . . .

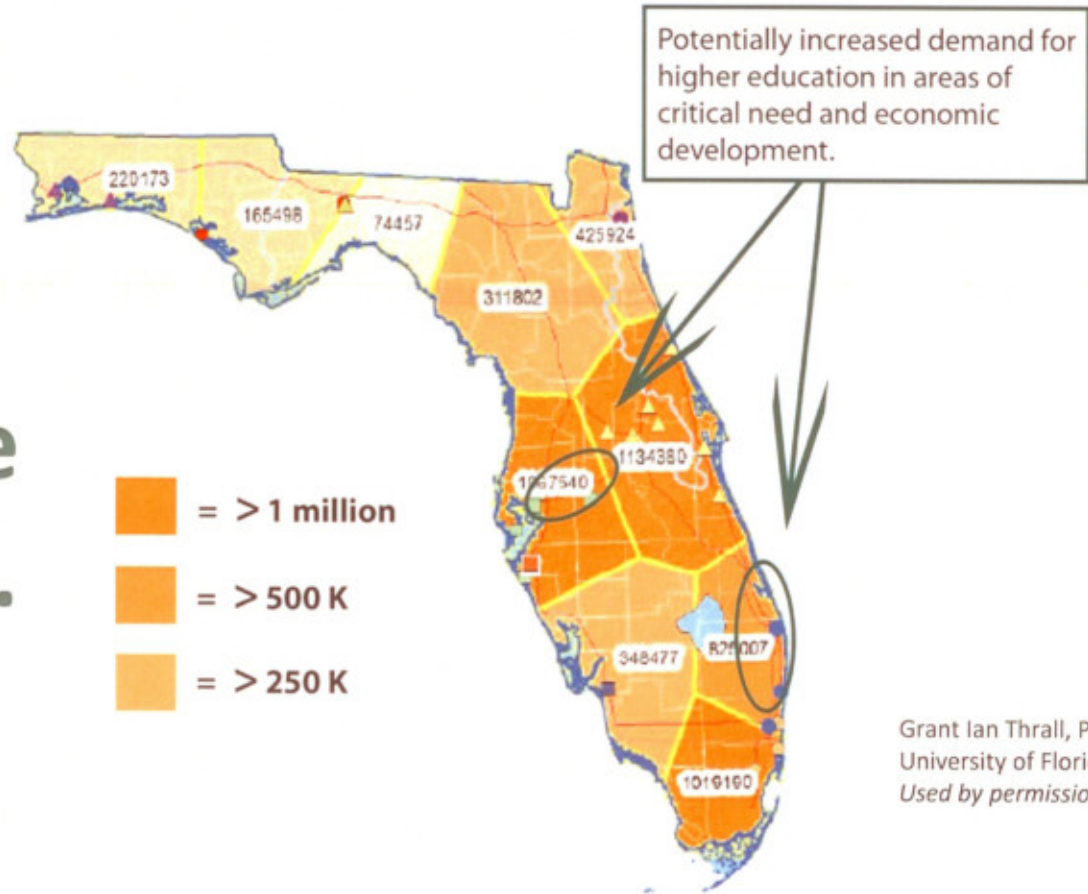

Grant Ian Thrall, Ph.D.  
University of Florida  
Used by permission

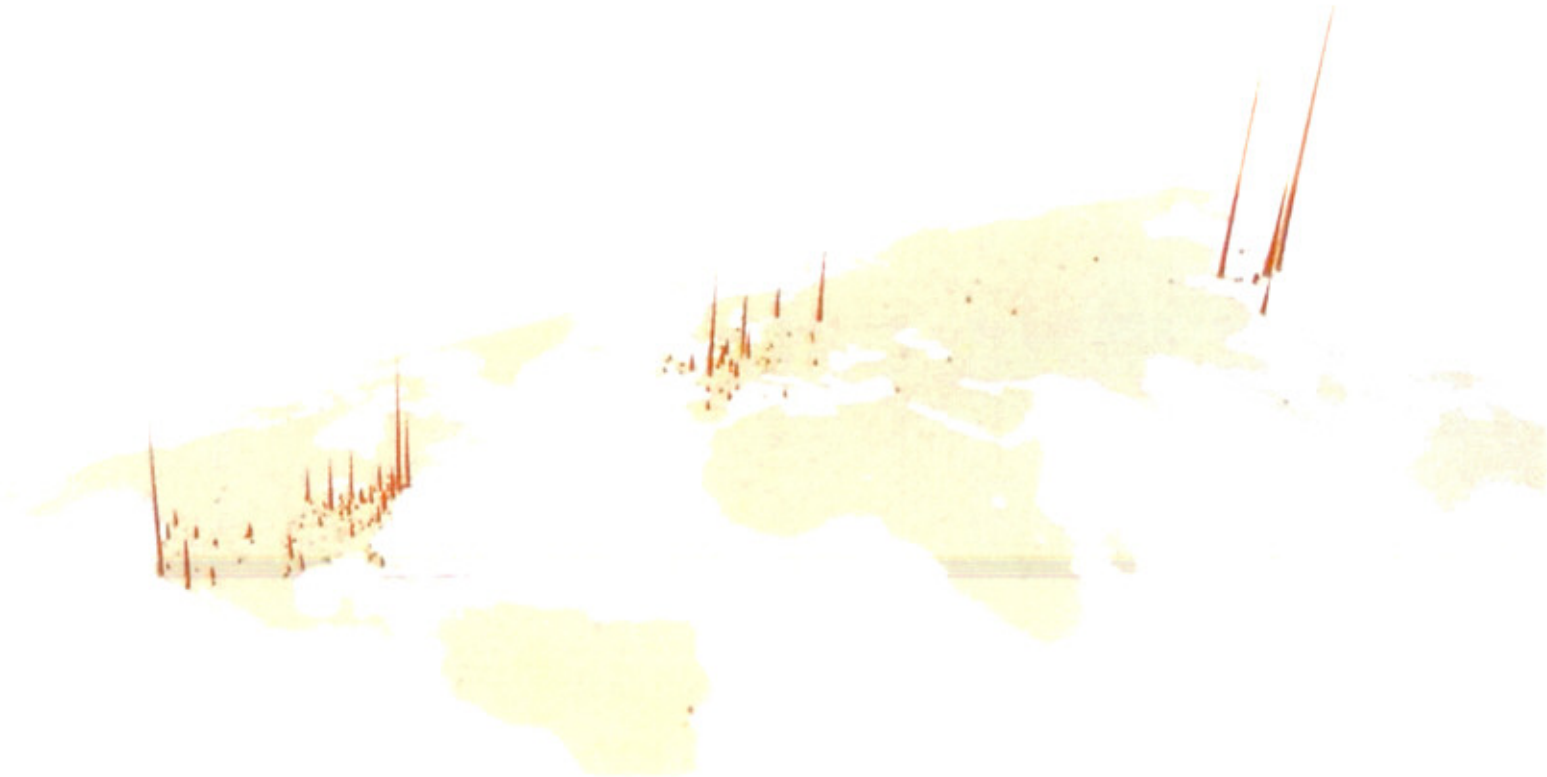

#### **THE GEOGRAPHY OF INNOVATION**

Commercial innovation and scientific advance are both highly concentrated—but not always in the same places. Several cities in East Asia—particularly in Japan—are home to prolific business innovation but still depend disproportionately on scientific breakthroughs made elsewhere. Likewise, some cities excel in scientific research but not in commercial adaptation. The few places that do both well are very strongly positioned in the global economy. These regions have little to fear, and much to gain, from continuing globalization.

Source: The Atlantic Monthly, Oct. 2005  
***“The World is Spikey”***  
World Intellectual Property Organization  
US Patent and Trademark Office

# The Challenge

“The US recently ranked 10<sup>th</sup> among developed countries in the percentage of young adults (ages 25-34) with college degrees.”



*Patrick Kelly, National Center for Higher Education Management Systems,  
Source: OECD, Education at a Glance (2009)*



# The Challenge



**Florida ranks 33<sup>rd</sup>  
in U.S. for STEM Jobs**

*Source: EMSI Complete Employment  
1<sup>st</sup> Quarter 2011*





UNIVERSITY OF  
SOUTH FLORIDA  
POLYTECHNIC

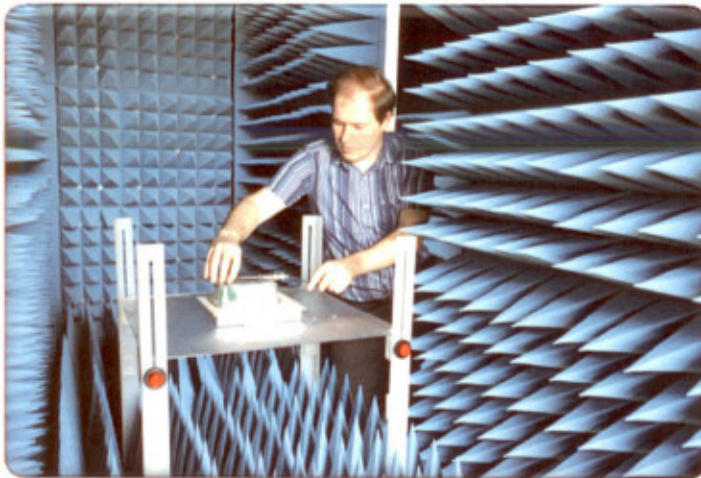

*“Our universities need to be graduating people in the majors where there are jobs.”*

Governor Rick Scott  
12.08.10

**the POLYTECHNIC**

**USF**

UNIVERSITY OF  
SOUTH FLORIDA  
POLYTECHNIC

# A Proven Model for Jobs

 **VirginiaTech**

**84%** of students  
have a career or  
grad program by  
graduation

**CAL POLY**

**81%** of Cal Poly  
graduates were working full  
time or attending graduate  
school within **3 MONTHS**  
of graduation

After **9 MONTHS**, **97%**  
had full time positions with  
**90%** finding jobs in their  
field

**Georgia  
Tech** 

**80%** of students  
have a career or  
grad program by  
graduation

**the POLYTECHNIC**



# A Proven Model for High Paying Jobs

## Median Graduate Salaries, Bachelor's Degree Grads

UNIVERSITY	STARTING SALARY	MID-CAREER SALARIES
CAL POLY	\$55,000	\$ 99,200
UC BERKELEY	\$53,100	\$109,000
UCLA	\$50,700	\$ 91,600
UC DAVIS	\$49,000	\$ 90,700
UC SAN DIEGO	\$48,700	\$ 99,700
UC SANTA BARBARA	\$47,600	\$ 96,400

*Nationwide survey of 1.4 million people / Compiled by College Portrait and PayScale.com*





“Those who say the University of South Florida Polytechnic will bring new jobs, well-employed graduates and talent retention are relying on solid facts.”

Mary Toothman  
The Ledger

**the POLYTECHNIC**

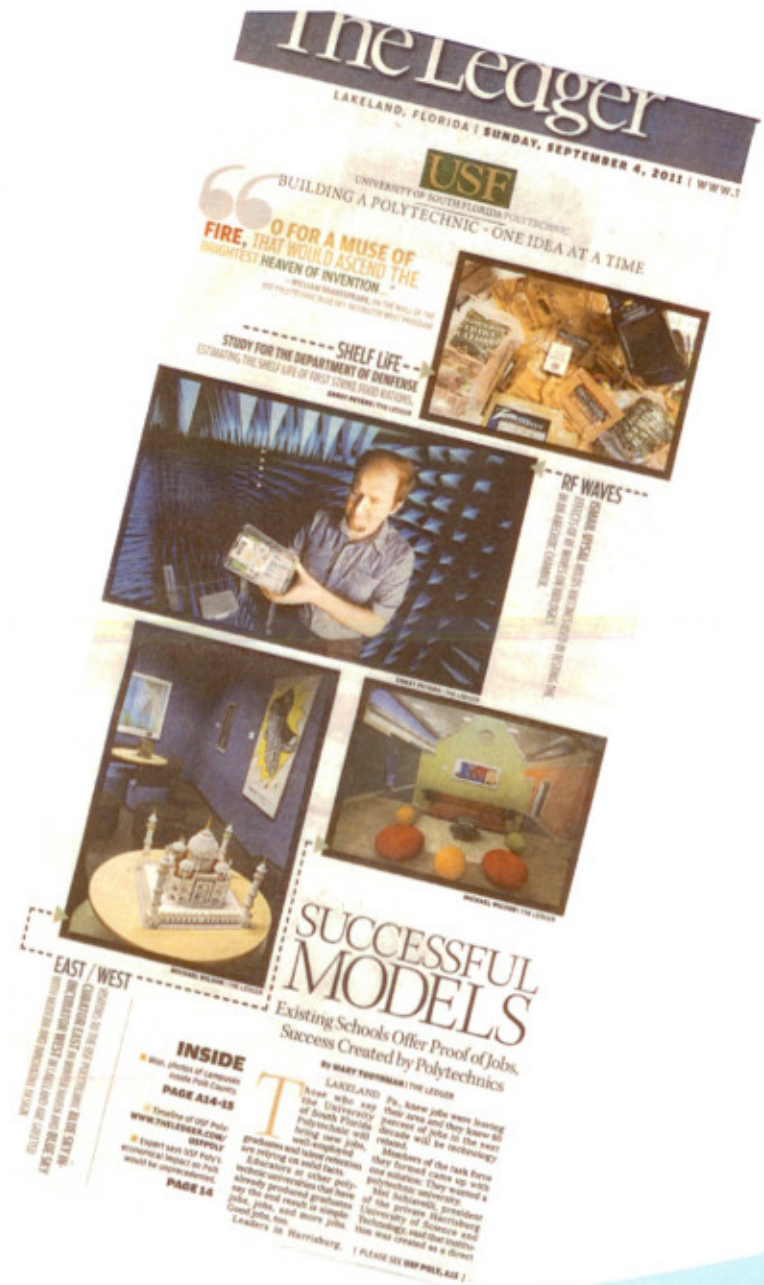



60 / 40

**the POLYTECHNIC**



**The Poly Promise:  
Every Student, Every Discipline,  
Every Semester**



# Polytechnic Learning Model

- Sage on the Stage vs. Guide on the Side
- Project-based learning
- Team-based environment
- Partnering with private sector to address real problems in real settings
- Internships and service learning in all disciplines
- Talent Management vs. Career Centers

**the POLYTECHNIC**

A decorative footer graphic consisting of a light blue wave-like shape that tapers from left to right, sitting above a solid dark green horizontal bar.

# The Vision: An Interconnected Curriculum

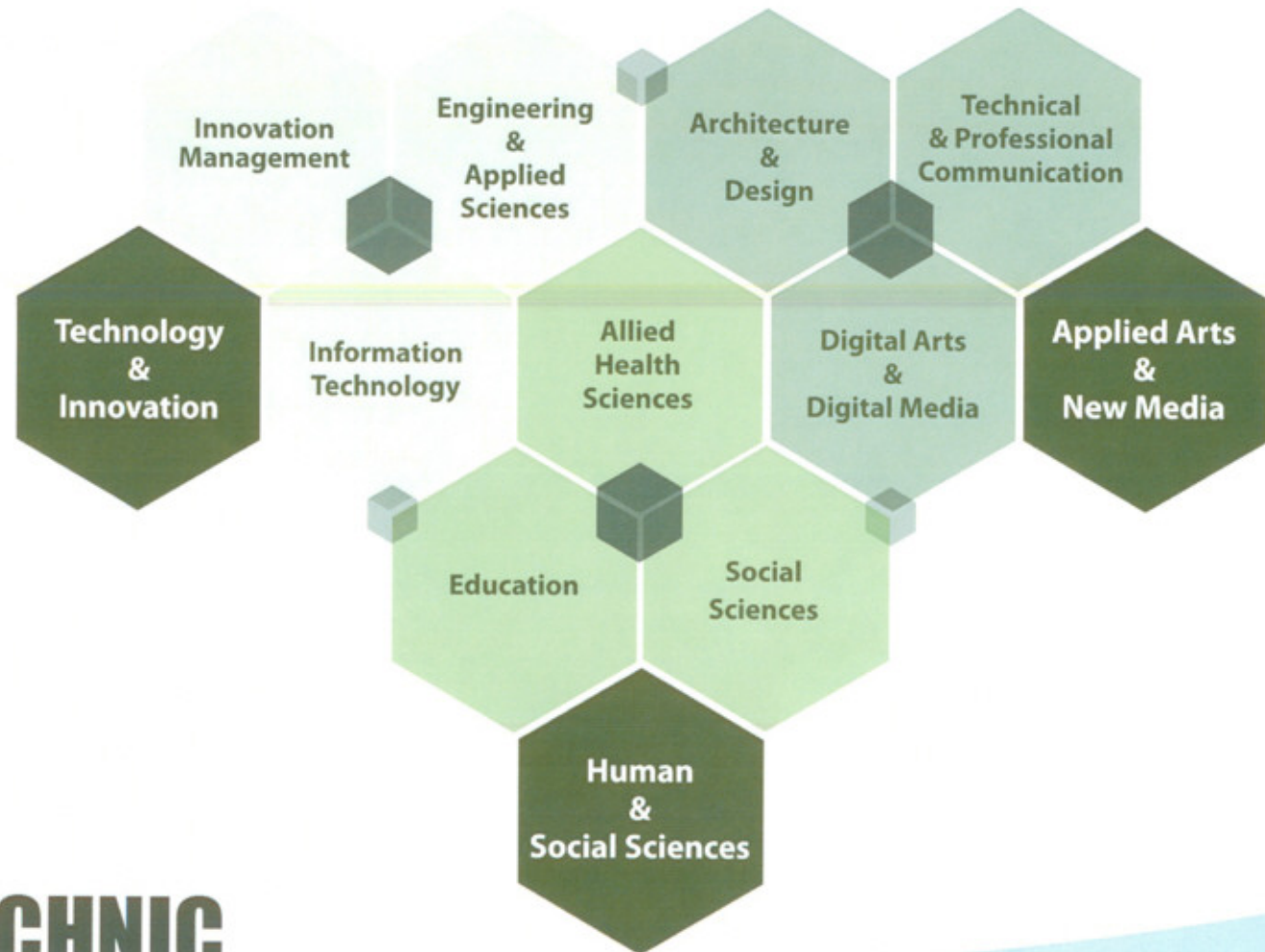





# What is the potential and the future of the Polytechnic within the SUS?

**the POLYTECHNIC**

A decorative footer graphic consisting of a light blue trapezoidal shape that tapers from left to right, sitting on a dark green horizontal bar.



# From Branch Campus to Destination University



**Access  
4X**

**the POLYTECHNIC**



# Governor Rick Scott

05.26.11

"...the campus at **USF-Polytechnic** will focus on the important **high-tech fields of the future**. The polytechnic concept ensures that **even graduates in degree programs outside of** the Science, Technology, Engineering, and Mathematics (**STEM**) areas will have training and education in those areas and develop skills applicable to the 21st century economy. Additionally, the construction of this campus will allow the state university system to continue to **meet the growing demand for access.**"

**the POLYTECHNIC**





# From Branch Campus to Destination University



**Concept:  
Reinventing  
Academic  
Calendar**



# From Branch Campus to Destination University

U.S. average to bachelors

Polytechnic goal

5.4  
yrs.

3.5  
yrs.

Reduce time...  
accelerate success!

Source: US Network for Education Information

# From Branch Campus to Destination University



## **Institutional Flexibility:**

- **Programs**
- **Recruitment**



# From Branch Campus to Destination University

## Student Life



**the** POLYTECHNIC



# From Branch Campus to Destination University

## Key Considerations:

- Students
- Accreditation
- New Campus Build-out





***Thank you!***

