

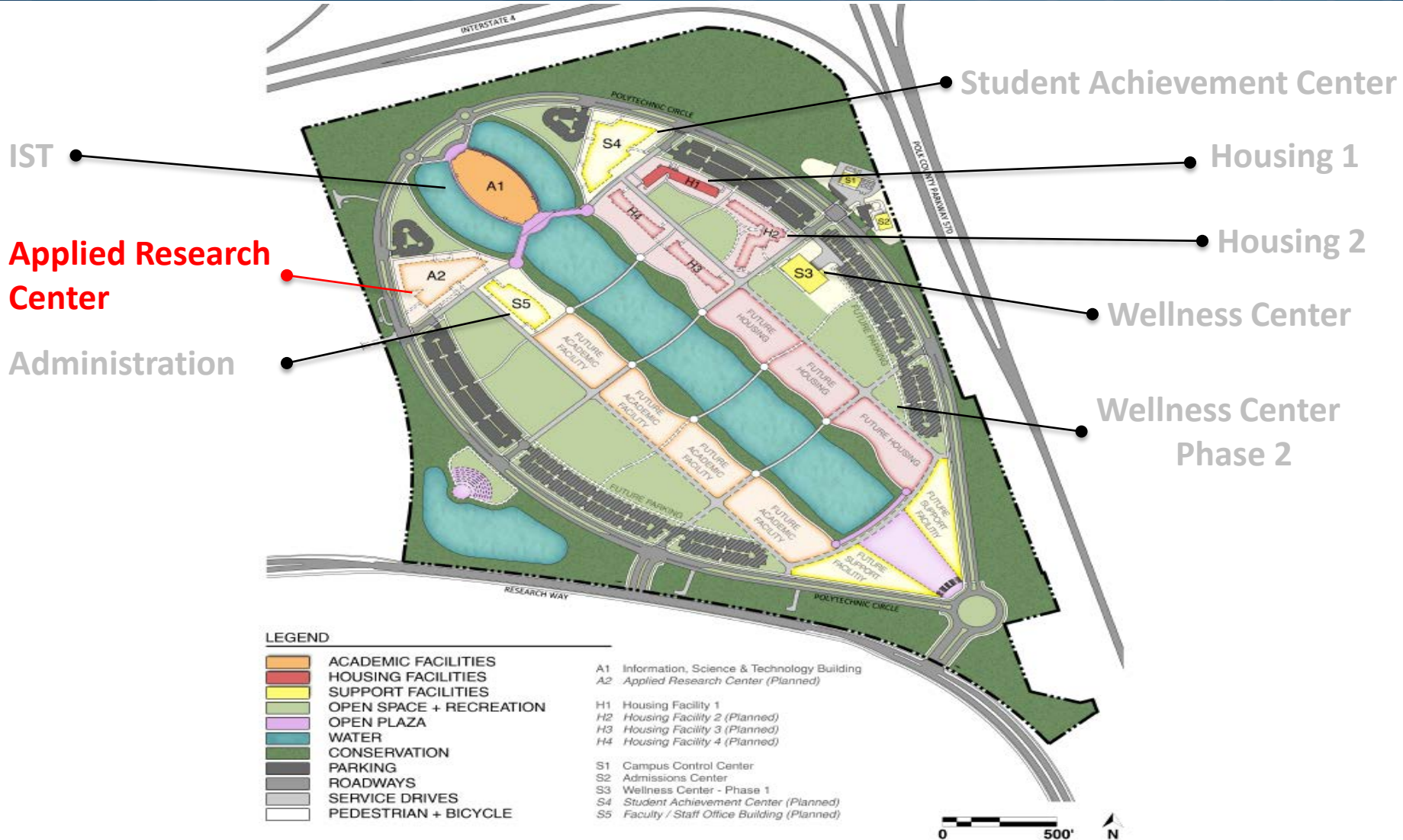

Florida Polytechnic University Applied Research Center \$35.3 M





Florida Polytechnic University Applied Research Center \$35.3 M

Demand Metrics

- Critical to faculty recruitment
- Cannibalizing classrooms to create needed research space
- Insufficient faculty offices
- Supports Poly's project based curriculum
- Essential to Poly's mission to catalyze economic development



Florida Polytechnic University Applied Research Center \$35.3 M

Additional Space

- GSF – 85,100
- NASF – 60,786
- Net to Gross Square Footage – 71.4%
- Current space to added space comparison
 - Current research lab space 12,313 NASF
 - Added research lab space 32,000 NASF

 - Current teaching lab space 27,588
 - Added teaching lab 7,000

 - Current office space 10,938
 - Added office space 21,500



Florida Polytechnic University Applied Research Center \$35.3 M

Institutes & Centers

- Will house University research related programs
 - SunTrax Autonomous & Connected Vehicle Research
 - Institute for Technology Entrepreneurship
 - Healthcare Informatics Center
 - Center for Applied Economic Research
 - Cybersecurity Lab



Florida Polytechnic University Applied Research Center \$35.3 M

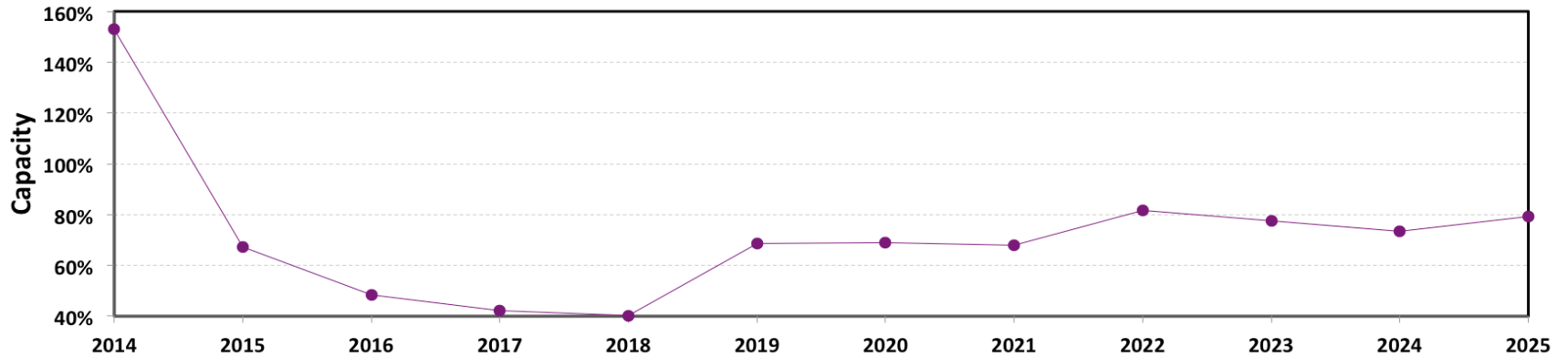

Wellness Center Phase 2



Applied Research Center (60,786 NASF)

Student Achievement Center (40,986 NASF)



Administration Building (38,786 NASF)





Florida Polytechnic University Applied Research Center \$35.3 M

Return On Investment

- Essential to achieving the University's mission to catalyze economic development
- Over \$5M in industry funded research
- Poly faculty and students are already conducting research with industry partners
- 100% STEM programs address BOG programs of strategic emphasis
- **1,748** students are projected to be enrolled by Fall 2019, expected completion date
 - All students are involved in design projects beginning in the freshman year
 - Hands on learning essential to retaining students
 - Industry wants students to be prepared for complex, real-world problems
 - Research – companies have already provided research projects for students



Florida Polytechnic University Applied Research Center \$35.3 M

REQUEST

<u>Total Project Budget:</u>	<u>\$35.3 M</u>
From PECO for 2016-17	\$ 5.0 M
From Carry Forward 2016-2017	\$ 5.0 M
Request for 2017-18	\$25.3 M



Florida Polytechnic University Applied Research Center \$35.3 M

Summary

- Space formula shows critical shortage of research space
- Lack of research space affecting faculty recruitment, research and student's problem-based learning curriculum
- Main priority is construction of an Applied Research Center
- Request the Applied Research Center be fully funded FY 2017-2018