



# BOARD *of* GOVERNORS

## State University System of Florida

# Florida Polytechnic University

## 2016 Work Plan Presentation

September 21, 2016



# Florida Polytechnic University

## 2016 Work Plan: Key Initiatives

### **Key Initiatives & Investments** *(within 3 years)*

#### **1. Retention and graduation rate**

- Innovative ways to track student progress
- Academic Success Center & Success Coaches

#### **2. Research infrastructure and support Economic Development**

- Academic Research Center
- Labs and state-of-the-art equipment
- Engaged Industry Partners
- Institute for Technology Entrepreneurship

#### **3. Faculty Recruitment**

- Credentials for project based curriculum and applied research
- Entrepreneurial mindset



# Florida Polytechnic University

## 2016 Work Plan: Retention Initiatives

- **Retention programs included in all Work Plans presented**
  - Academic Success Center (tutors, embedded tutors, mid-terms)
  - Summer Math “Bootcamps”
  - Advanced teaching methods (modules, applied, primers)
  - Success Coaches
- **Better admissions using predictive analytics**
  - Reduce admissions to become more selective
  - Academic Quality (GPA, SAT, ACT)
  - Concurrent factors (faculty status, time-of-day)
  - Grit tests
- **Introduction of “retreat” majors**
  - Programs consistent with Poly mission
  - “Going Backwards”



# Florida Polytechnic University 2016 Work Plan: Retention Initiatives Outcomes

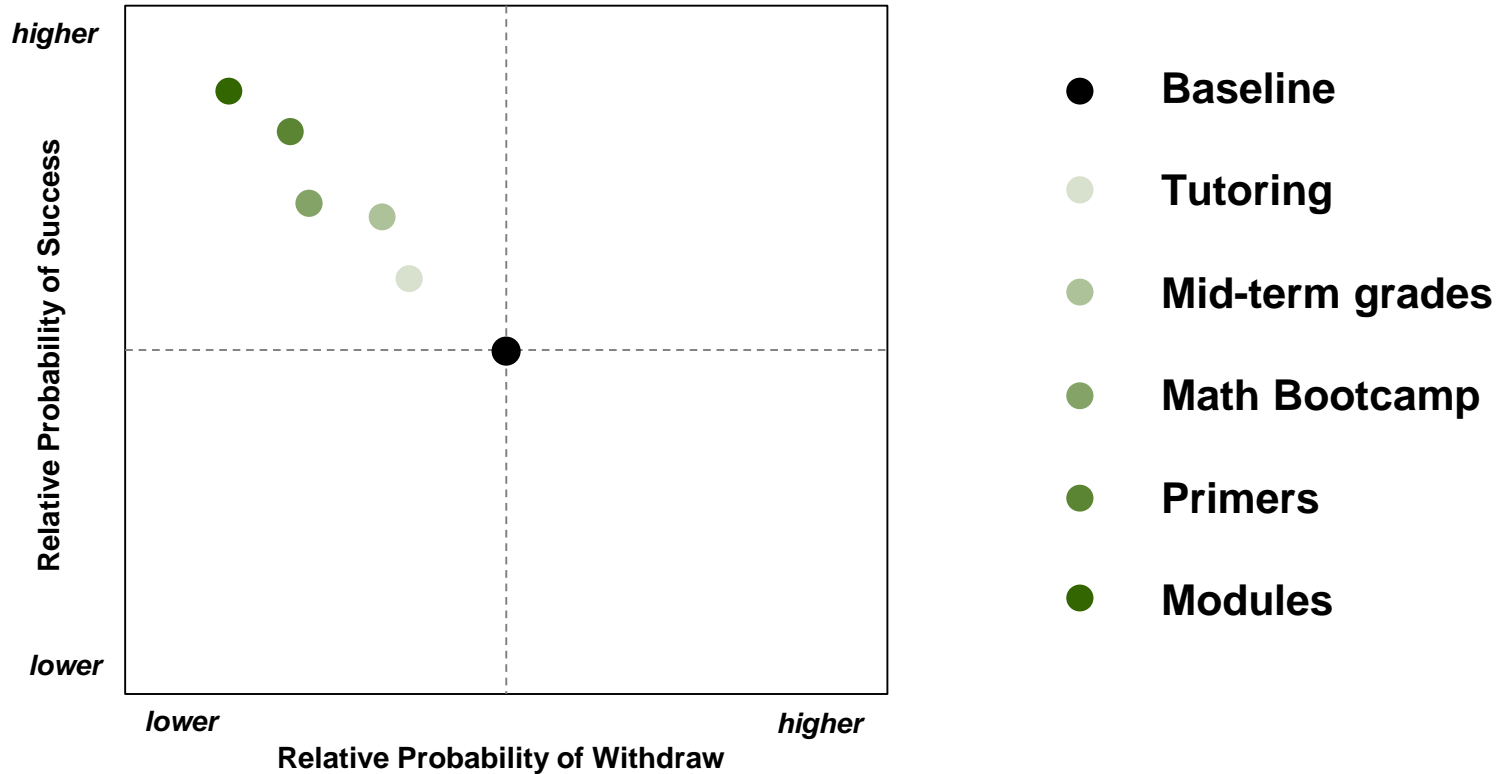

**Initiatives that required students attendance outside the classroom were less effective than classroom-based approaches**



# Florida Polytechnic University 2016 Work Plan: Research Infrastructure Initiatives

Applied  
Research Center

Eng. Shop (TBD)

Parking Lots

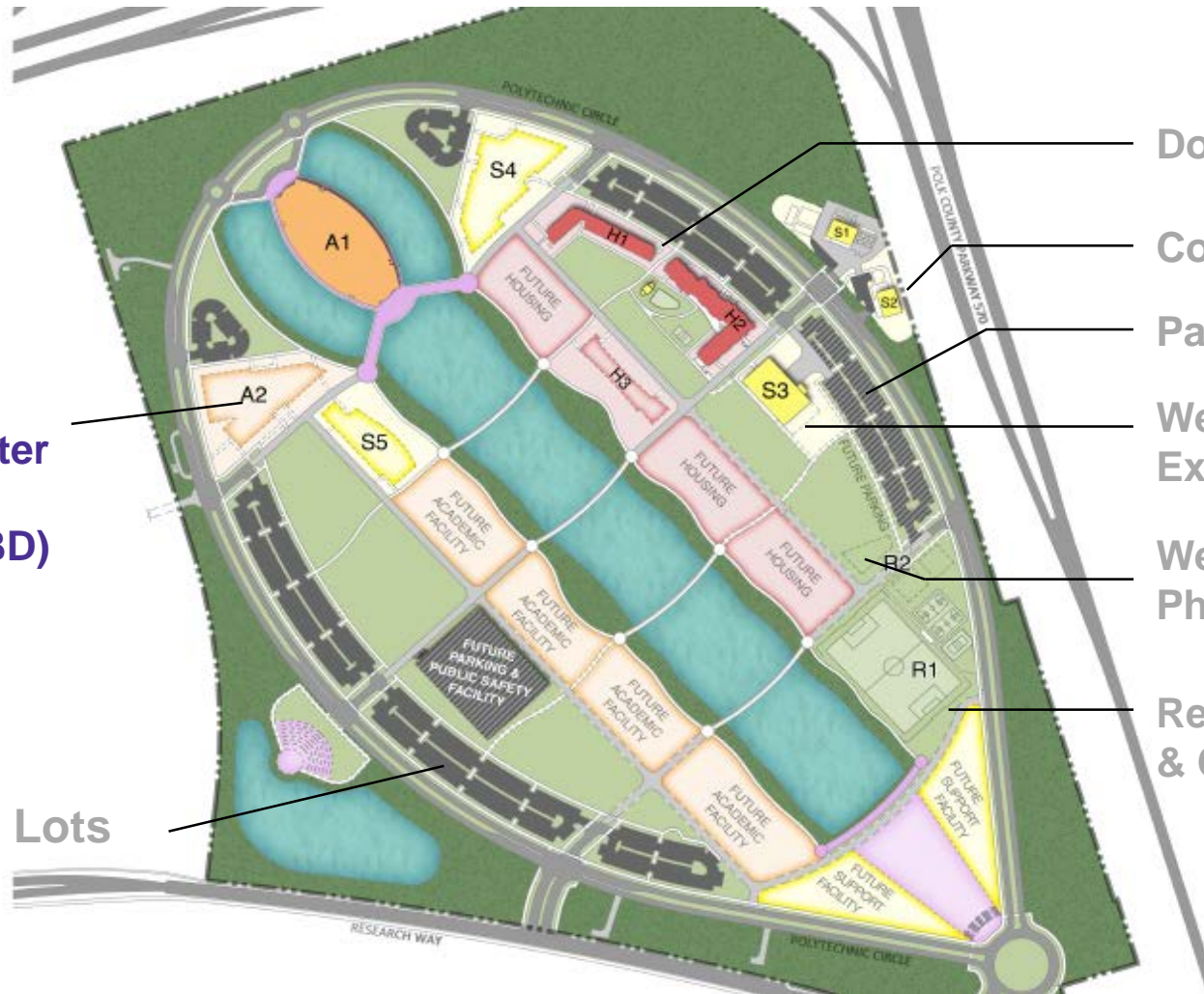

Dorms 1 & 2

Cooling Tower

Parking Lot

Wellness Center  
Expansion

Wellness  
Phase 2

Recreation Field  
& Courts



# Florida Polytechnic University

## 2016 Work Plan: Faculty Recruitment Initiatives

- **Full-time faculty**
  - 25 new hires
  - 32 returning
- **Adjunct faculty**
  - Adjunct faculty fair
  - 25 total
- **Future faculty hires strategy**
  - Area of expertise (focus)
- **Student to Faculty Ratio (20:1)**





# Florida Polytechnic University 2016 Work Plan: Performance Funding

## Performance Based Funding Metric Goals

METRICS	2015 ACTUAL	2016 ACTUAL	2017 GOALS	2018 GOALS	2019 GOALS	2020 GOALS	OUTLOOK
<b>Percent of Bachelor's Graduates Enrolled or Employed (\$25,000+) in the U.S. One Year After Graduation</b>					75%	75%	
<b>Median Wages of Bachelor's Graduates Employed Full-time in Florida One-Year After Graduation</b>					\$50,000	\$50,000	
<b>Average Cost per Bachelor's Degree</b> Costs to the University					\$75,000	\$75,000	
<b>FTIC 6 year Graduation Rate</b> Includes full- and part-time students							
<b>Academic Progress Rate</b> FTIC 2 year Retention Rate with GPA>2		72.9%	74%	75%	78%	80%	
<b>University Access Rate</b> Percent of Fall Undergraduates with a Pell grant					27.5%	30%	
<b>Bachelor's Degrees Awarded Within Programs of Strategic Emphasis</b>				100%	100%	100%	
<b>Graduate Degrees Awarded Within Programs of Strategic Emphasis</b>				100%	100%	100%	



# Florida Polytechnic University

## 2016 Work Plan: Performance Indicators

### Teaching & Learning Metrics

METRICS	GOAL (YEAR)	JUSTIFICATION
Freshmen in Top 10% of High School	35% (2016)	New College (45%)
Time to Degree	5.5 (2018)	Engineering Peers
Four-Year FTIC Graduation Rate	60% (2019)	SUS Peers
Bachelor's Degrees Awarded	11 (2017)	Florida Poly Projections
Graduate Degrees Awarded	23 (2017)	Florida Poly Projections
Bachelor's Degrees Awarded to African American & Hispanic Students	23% (2017)	Forecast
Adult (25+) Undergraduates Enrolled	8% (2014)	Forecast
Percent of Undergraduate FTE in Online Class	7% (2018)	Florida Poly Projections





# Florida Polytechnic University 2016 Work Plan: Performance Indicators

## Institution Specific Goals

METRICS	2017 GOAL	2020 GOAL
# of Industry Partnerships Providing Employment & Research Opportunities for Students and/or Faculty	23	35
% of Graduates Who Completed an Internship Program	60%	80%
FTIC Targeted Academic Quality Relative to Selectivity (current: 84%)	85%	86%
Student to Faculty Ratio (current: 18:1)	20:1	20:1
% of Students Beginning a Startup Company or Working in a Startup	10%	20%



# Florida Polytechnic University 2016 Work Plan: Enrollment

## Planned Enrollment Growth

HEADCOUNT	FALL 2015 ACTUAL	FALL 2016 GOAL	FALL 2017 GOAL	FALL 2018 GOAL	FALL 2019 GOAL
UNDERGRADUATE	887	1,273	1,542	1,631	1,655
GRADUATE	37	61	73	86	87
HS DUAL ENROLLED	0	1	1	5	5
OTHER UNCLASSIFIED	0	0	0	0	0
<b>TOTAL</b>	<b>924</b>	<b>1,335</b>	<b>1,616</b>	<b>1,722</b>	<b>1,748</b>

## Distance Learning as a Percentage of Total Enrollment

FULL-TIME EQUIVALENT (FTE)	2014-15 ACTUAL	2015-16 GOAL	2016-17 GOAL	2017-18 GOAL	2018-19 GOAL
UNDERGRADUATE					7%
GRADUATE					0%
<b>TOTAL</b>					<b>7%</b>

Note: Distance Learning is a course in which at least 80 percent of the direct instruction of the course is delivered using some form of technology when the student and instructor are separated by time or space, or both (per 1009.24(17), F.S.).



# BOARD *of* GOVERNORS

## State University System of Florida

[www.flbog.edu](http://www.flbog.edu)



# Florida Polytechnic University 2016 Work Plan: Comparative Facilities Costs

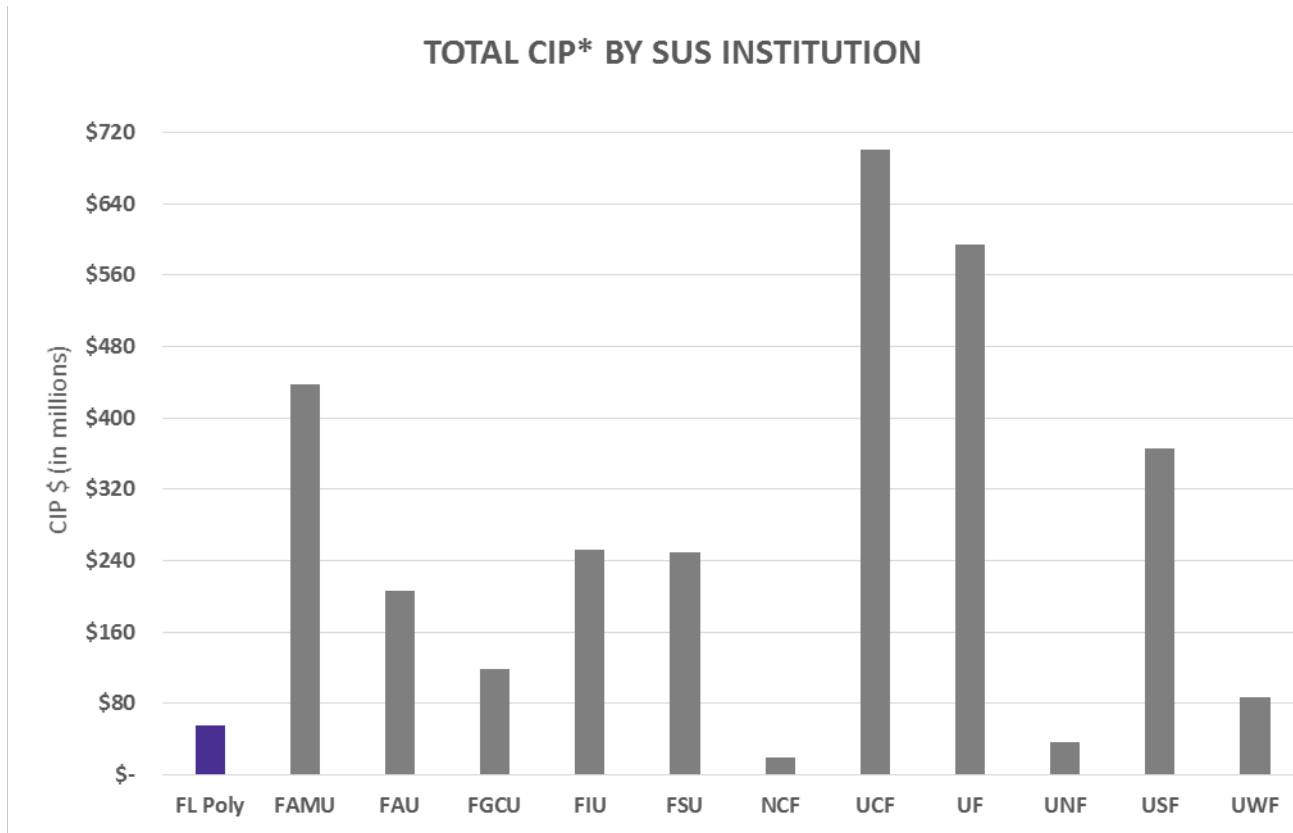

\*Five year CIP data